

Downtown Westminster Projects

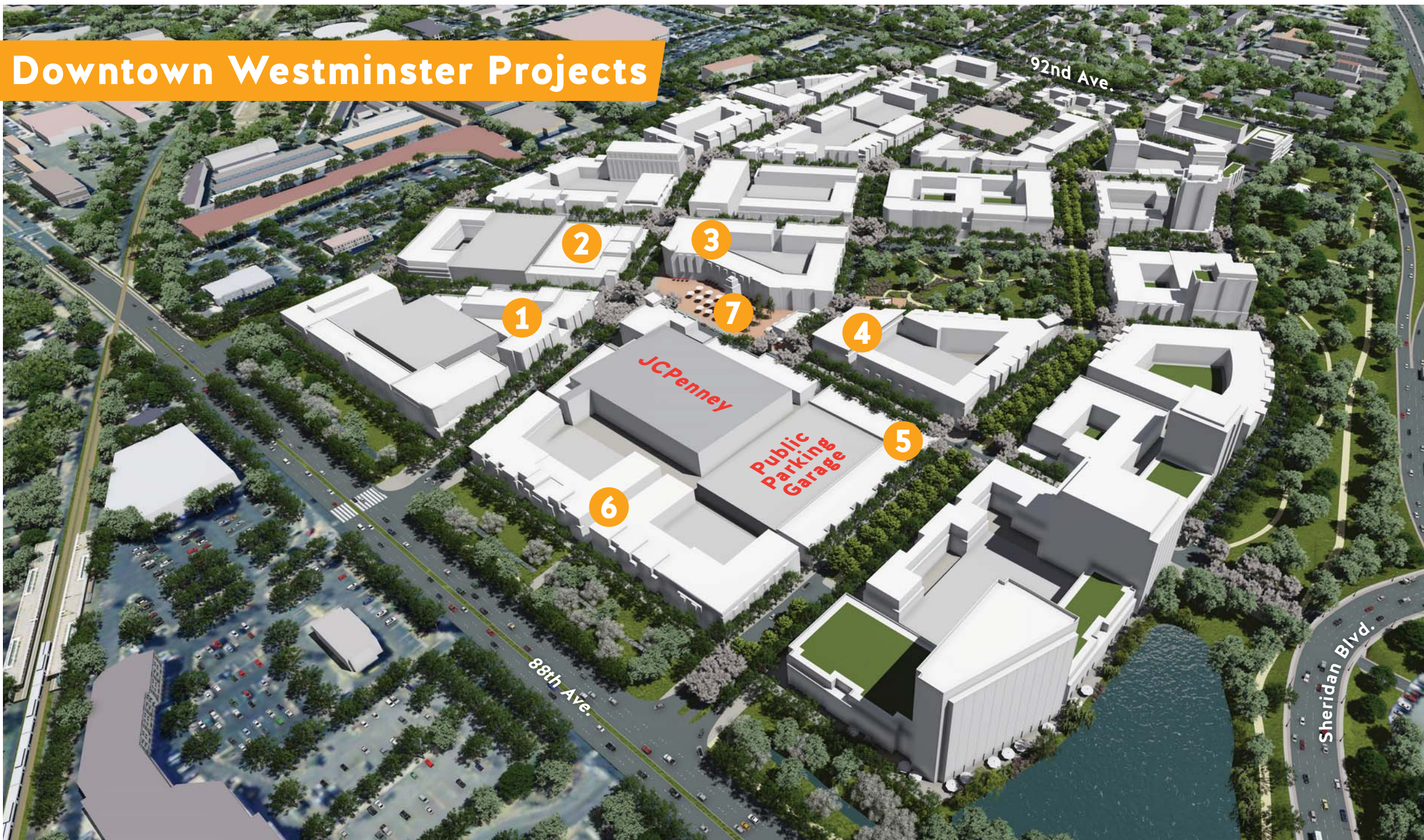

7

OPENING 2Q 2018
Central Square
 1.2 acre plaza



6

OPENING 4Q 2018
Ascent Westminster
 270 units/24k s.f. retail



5

OPENING 4Q 2018
Mile High/Koelbel/LongsPeak
 118 units/20k s.f. retail

1



OPENING 1Q 2019
Origin Hotel/Marczyk Fine Foods
 125 room boutique hotel w/retail

2



OPENING 4Q 2018
Alamo Draft House
 9 screen theater/restaurant

3



OPENING 3Q 2019
Sherman Associates
 240 units/38k s.f. retail

4



OPENING 1Q 2019
GRID Collaborative/Solera Salon
 80k s.f. office/30k s.f. retail



DOWNTOWN
 WESTMINSTER

www.DowntownWestminster.us

Sarah: snurmela@cityofwestminster.us
 John: jburke@cityofwestminster.us