

DOWNTOWN WESTMINSTER

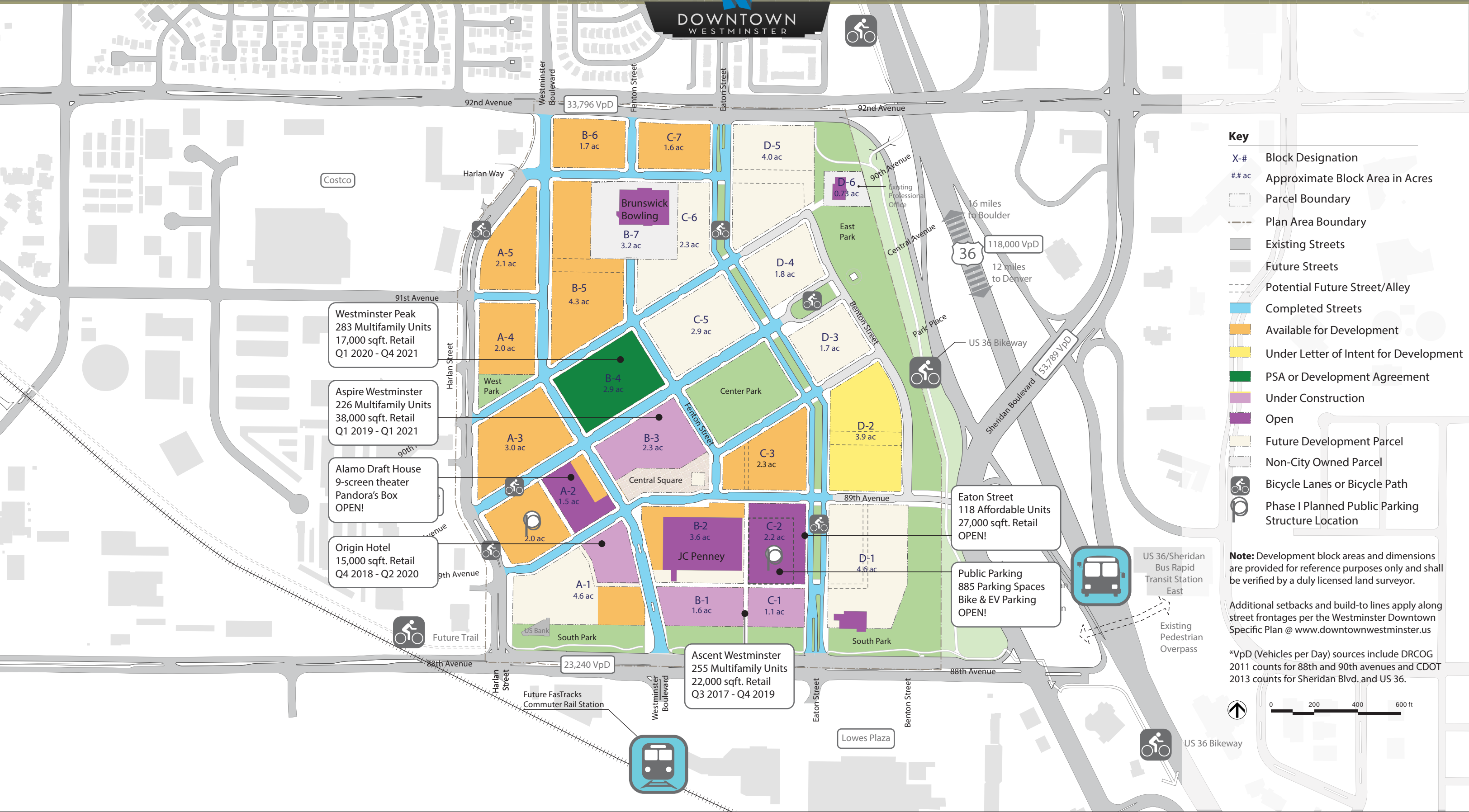

- Key**
- X-# Block Designation
 - ## ac Approximate Block Area in Acres
 - Parcel Boundary
 - Plan Area Boundary
 - Existing Streets
 - Future Streets
 - Potential Future Street/Alley
 - Completed Streets
 - Available for Development
 - Under Letter of Intent for Development
 - PSA or Development Agreement
 - Under Construction
 - Open
 - Future Development Parcel
 - Non-City Owned Parcel
 - Bicycle Lanes or Bicycle Path
 - Phase I Planned Public Parking Structure Location

Note: Development block areas and dimensions are provided for reference purposes only and shall be verified by a duly licensed land surveyor.

Additional setbacks and build-to lines apply along street frontages per the Westminister Downtown Specific Plan @ www.downtownwestminster.us

*VpD (Vehicles per Day) sources include DRCOG 2011 counts for 88th and 90th avenues and CDOT 2013 counts for Sheridan Blvd. and US 36.

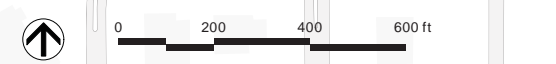

DOWNTOWN WESTMINSTER

Downtown Westminster Projects

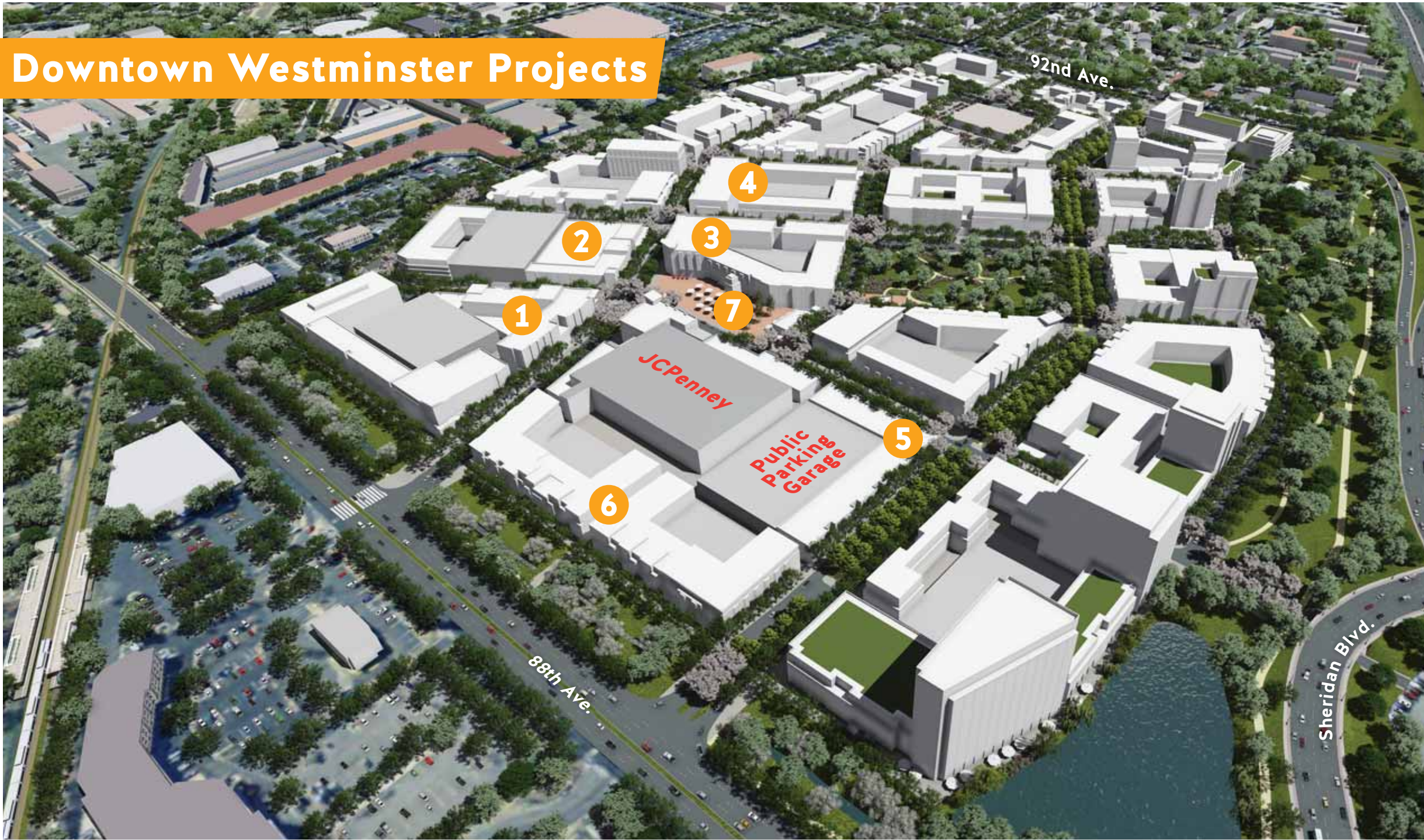

7
OPEN!
Central Square
1.2 acre plaza



6
OPENING Q4 2019
Ascent Westminster
255 units/22k s.f. retail



5
OPEN!
8877 Eaton
118 units/27k s.f. retail



1
OPENING Q2 2020
Origin Hotel
125-room boutique hotel/15k s.f. retail



2
OPEN!
Alamo Drafthouse
9-screen theater/restaurant



3
OPENING Q1 2021
Aspire Westminster
226 units/38k s.f. retail



4
OPENING Q4 2021
Westminster Peak
283 units/17k s.f. retail



DOWNTOWN WESTMINSTER

www.DowntownWestminster.us

Sarah: snurmela@cityofwestminster.us

John: jburke@cityofwestminster.us